



# 2-DOOR FOLDING CRATE

## INSTALLING THE DIVIDER PANEL

Perform this step only if you intend to use the included divider panel.

Insert the divider panel with the hooks facing toward the back of the crate. Attach the hooks to a vertical wire on each side. Attach one side at a time.

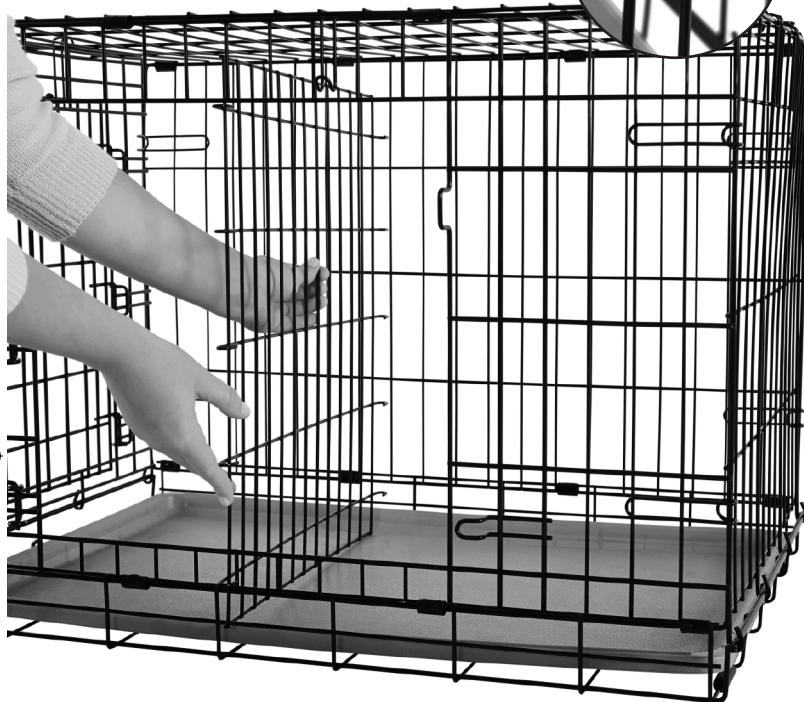

**Note:** Make sure the divider panel is straight and that you have placed it so your puppy has enough room to enter the crate, turn around and lie down. Place the divider panel as low and close to the plastic pan as possible to minimize the gap at the bottom. Be sure to adjust your divider panel as your puppy grows.

## MAINTENANCE

Keep your dog's crate looking neat and shiny, and you'll both have a happier home! Protect the finish of your crate and the bottom pan by using only mild, non-abrasive cleaners and water. Any coarse scrubbing or abrasive materials could damage the finish.

Do not expose the plastic pan to direct sunlight for extended periods of time as this may lead to warping or damage of the pan.

To help reduce noise, place a piece of carpet or cut a piece of cardboard from the crate carton and place it inside the crate beneath the pan.

## IMPORTANT GUIDELINES FOR USE

- For your dog's safety, never leave your dog in the crate unsupervised until he feels comfortable with his crate.
- Don't place toys inside crate with your dog.
- Don't place more than one dog in crate at one time.
- Do not place anything on top of the crate (lightweight crate cover, excluded.)
- Never allow children to play in or around crate.
- Keep crate door(s) closed and locked when not in use.
- Never use the crate with an untrained or aggressive dog.
- Never leave dogs in the crate for long periods of time, especially during extreme temperatures.
- For the health and safety of your dog, clean the crate, tray and mats regularly.

## LIMITED MANUFACTURER'S WARRANTY

1. For two (2) years from the date of original purchase, the manufacturer warrants to the purchaser of this dog home that, should it prove defective by reason of improper workmanship and/or material, the manufacturer will repair or replace, at its option, any defective part of the dog home, without charge for the part or for shipping. Replacement parts are warranted for the remainder of the original period.
  2. THIS WARRANTY DOES NOT COVER defects in the dog home caused by any animal, any physical abuse to or misuse of the dog home, any damage caused by the original purchaser or any third party, or any defects arising or discovered more than one (2) years from the original retail purchase date.
  3. STEPS TO OBTAIN WARRANTY SERVICE:
    - A. The purchaser must call the manufacturer's HELPLINE, 888-824-7257, to report the alleged defect to a customer service representative or obtain missing parts.
    - B. The customer service representative will determine if the defect is covered by this warranty, and if it is, will authorize and instruct the purchaser in how to obtain corrective action.
    - C. The manufacturer may require the purchaser to present the sales receipt or other proof of purchase prior to authorizing any return or replacement. No returns or replacements will be permitted without proper authorization. If a return or replacement is authorized, you may be requested to return the item to the manufacturer or to make the item available for pick-up by the manufacturer.
  4. ANY EXPRESS WARRANTY NOT PROVIDED IN THIS WARRANTY DOCUMENT, AND ANY REMEDY FOR BREACH OF CONTRACT THAT, BUT FOR THIS PROVISION, MIGHT ARISE BY IMPLICATION OR OPERATION OF LAW, IS HEREBY EXCLUDED AND DISCLAIMED. THE IMPLIED WARRANTIES OF MERCHANTABILITY AND OF FITNESS FOR ANY PARTICULAR PURPOSE ARE EXPRESSLY LIMITED TO A TERM OF TWO (2) YEARS. SOME STATES DO NOT ALLOW LIMITATIONS ON HOW LONG AN IMPLIED WARRANTY LASTS, SO THE ABOVE LIMITATIONS MAY NOT APPLY TO YOU.
  5. UNDER NO CIRCUMSTANCES SHALL THE MANUFACTURER BE LIABLE TO PURCHASER OR ANY OTHER PERSON OR ANY SPECIAL, INCIDENTAL OR CONSEQUENTIAL DAMAGES, WHETHER ARISING OUT OF BREACH OF WARRANTY, BREACH OF CONTRACT, OR OTHERWISE. SOME STATES DO NOT ALLOW THE EXCLUSION OR LIMITATIONS OF INCIDENTAL OR CONSEQUENTIAL DAMAGES, SO THE ABOVE LIMITATIONS OR EXCLUSION MAY NOT APPLY TO YOU.
  6. This warranty gives you specific legal rights, and you may also have other rights which vary from state to state.
- For questions, call 888-824-7257.

**WARNING: For Dog Use Only. Not Suitable For Children.** Intended to be used for dog training, and/or den. Choose the appropriate crate based on your dog's size. To prevent serious dog injury or entrapment, always secure ALL door and plastic pan locks completely. Supervise dog closely until it is fully comfortable with the crate. Inspect regularly and replace if any part becomes damaged.



# 2-DOOR FOLDING CRATE

Before use, read these instructions and the *You & Me Crate Training Guide* included with the crate.

We know you and your dog are excited to explore your new crate once it's assembled! But for your dog's safety, remove clothing before entering the crate. Once inside the crate, remove collar, lead, harness and tags before securing the door.

If your dog has never been confined in an enclosure, proper training is required so your dog can become acquainted with the enclosure. Forced confinement without proper training could result in serious harm to your dog. For your dog's safety and to keep the crate a positive tool, we've included a *You & Me Crate Training Guide* with this product. Please read this guide before introducing the crate to your dog, and save it for reference. If you are leaving your dog with a family member, friend or sitter, share this guide to be sure they have a complete understanding of how to use this product safely.

Remove all parts from the box. Keep the box and packing material until the product is assembled. In case of return or exchange, failure to return product in similar condition as received could result in limited reimbursement. Please save sales receipt as proof of purchase for warranty purposes. Check to ensure you have all the parts below. If you discover any parts are missing, immediately call our toll-free service helpline.

**Parts Include:** Crate, Plastic Pan, Divider Panel

## TOLL-FREE SERVICE HELPLINE

If you have any problems or questions with the assembly of your new dog home, call our Service Helpline at:

**888-824-7257**

4:00 a.m. to 10:00 p.m. (PST)  
7 days/week

## ASSEMBLY INSTRUCTIONS

**STEP 1** Lay the crate on flat surface so the plastic pan is on the bottom and the wires are facing up. Unhook the locking device located on the side of the crate.

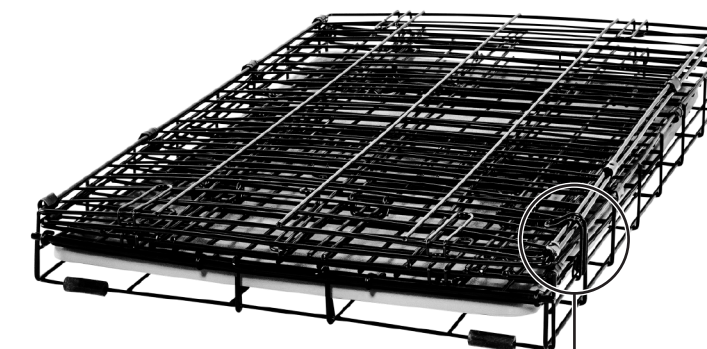

**STEP 2** Grab any wire on the top panel and swing the panel over like a page of a book. Then grab the top and side panel and pull upward. This will form the shape of the crate.

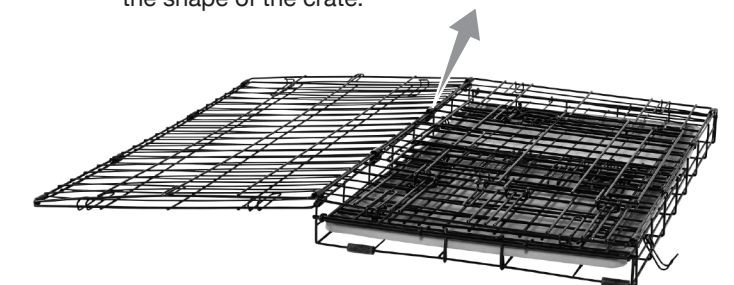



# 2-DOOR FOLDING CRATE

STEP 3

**IMPORTANT: This step is critical to the safe assembly of the crate.** As illustrated, make sure the bottoms of the two side panels rest inside the bottom panel and that one edge of the top panel is "inside" the side panel and the other is "outside" of the second side panel.

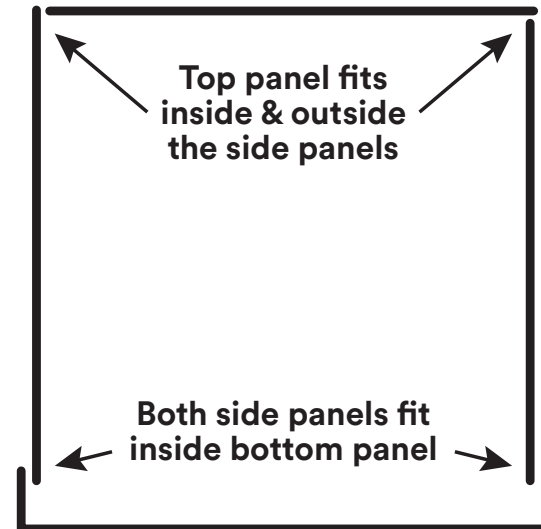

STEP 4

Reach in the crate and pull the door panel forward until it fits into the hooks on the ends of the side panel. Ensure all hooks are engaged with the panel; repeat with the end panel.



STEP 5

To secure the door panel to the top panel, gently pull forward on the door panel while pushing down on the top panel. Then fit the hooks over the end wire on the top. Repeat with the end panel.



Crate sizes 42" and 48" have a "U-Wire" on the top panel that hooks over the end panel.



The 36" crate has a "U-Wire" on the top panel that rests on top of the end panel.



Crate sizes 24" and 30" do not have a "U-Wire".



STEP 6

Both doors may be removed at any time. To remove a door, swing it out in the fully open position, then lift the door to disengage the pins from the looped hinges and remove.

To install a door, start with the door in a fully open position. Align the pins on the door with the looped hinges on the crate, then guide the pins down through the loops.



STEP 7

For the safety of your pet, the pan stop secures the removable plastic pan inside the crate. After removing the pan, always be sure to secure the pan back in place by hooking the pan stop up over the bottom wire of the front panel.



STEP 8

Clip and remove any zip ties that remain on the crate.

## TO OPEN THE DOORS

Lift and slide the slide-bolt latch to disengage. Grab the wire handle in the center of the door and lift the door upward so the notches clear the LapLocks, then swing open.



LapLock detail for 36", 42" and 48" crates

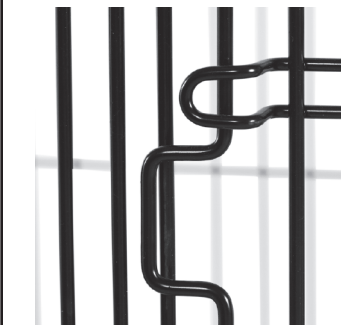

LapLock detail for 24" and 30" crates

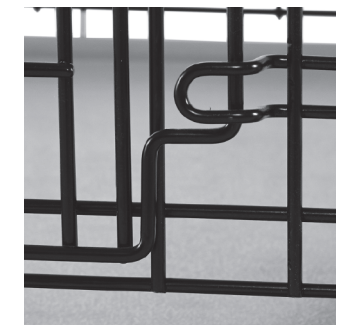

## TO CLOSE THE DOORS

Swing the door back toward the crate. Grab the wire handle in the center of the door, lift the door upward and push the door firmly against crate before lowering, securing the door's far right vertical wire behind the LapLocks. Engage the slide-bolt latch and make sure the slide-bolt handle is in the down position.