

IMAGITARIUM VERSA

3.7G / 6.6G / 9.5G



Wash your hands and arms before you work on your aquarium. It is very important to remove dirt, moisturizer and other impurities.



Unpack all filter media and rinse with cold, fresh water before initial use.

Rinse the inside of the aquarium with water to remove any dust or other contaminants.



Read and follow all safety instructions and important notices in these instructions and on the product itself.

All species of aquatic life have specific requirements for their care. Please seek advice from your local Petco pet care center for correct care requirements and species compatibility.

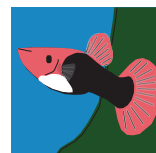

IMPORTANT SAFEGUARDS

If you are in any doubt about the electrical installation or safety of this product you must consult a qualified electrician.

Water and electricity can be dangerous. Do not attempt repairs yourself. Return the appliance to your local Petco pet care center if there are any concerns.



Make sure any component mounted on a tank is securely installed before operating it.

Children should be supervised when using this item.

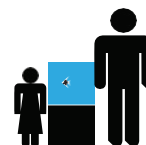

If the appliance or any electrical component of the appliance (non-immersible equipment only) falls into the water or gets wet, do not reach for it. Unplug it and then retrieve it.



Arrange a drip loop for each cable to stop water from entering the power socket. If the plug or the socket does get wet, disconnect the fuse or circuit breaker before unplugging the power plug.

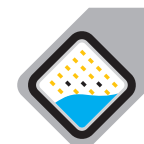

If the appliance shows any sign of water leakage, unplug it from the power source. Examine the appliance after installation. It should not be plugged in if there is water on parts that are not intended to be wet.

IMAGITARIUM VERSA

3.7G / 6.6G / 9.5G



Do not operate the appliance if it has a damaged cord or plug, or is malfunctioning or damaged in any manner.



Do not use the appliance for reasons other than the intended use.



Ensure your hands are dry when turning the power switch on or off and when inserting or removing the power cable from the socket.



Do not install or pet care center the appliance where it will be exposed to weather or temperatures below freezing.

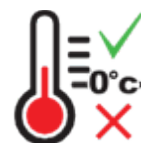

Never yank the cable to pull it from the socket. Pull the plug carefully to disconnect.



This product is intended for indoor use only.



Unplug the appliance from the electrical outlet when not in use or before any type of maintenance or cleaning.

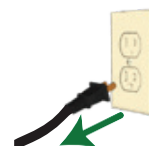



IMAGITARIUM VERSA



3.7G / 6.6G / 9.5G

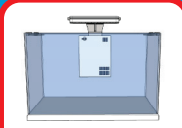
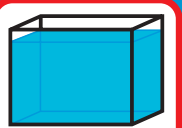

SPECIFICATIONS

 MODEL	 AQUARIUM VOLUME	 DIMENSIONS	 FILTER FLOW RATE
Versa 3.7	3.7G	11.8 IN L x 8.6 IN D x 10.6 IN H	Adjustable from 8-39 G/hr
Versa 6.6	6.6G	15.7 IN L x 9.8 IN D x 12.2 IN H	Adjustable from 8-79 G/hr
Versa 9.5	9.5G	19.6 IN L x 9.8 IN D x 13.3 IN H	Adjustable from 8-79 G/hr

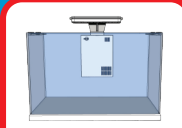
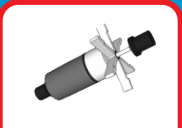
REPLACEMENT PARTS & FILTER MEDIA

 MODEL	 Impeller	 CARBON CARTRIDGE	 Filter SPONGE
Versa 3.7	169i	V	-
Versa 6.6	160i	D	Slim Rectangle Sponge
Versa 9.5	160i	D	Slim Rectangle Sponge

Carefully unpack the aquarium making sure you keep all the packing material until all the parts of the product have been found and the product has been assembled.

This product is shipped to you in a factory sealed carton. Should the product malfunction in any way or if the unit is damaged and requires replacement, contact the retailer where the product was purchased for inspection.

IMAGITARIUM VERSA 3.7G / 6.6G / 9.5G



WHAT'S IN THE BOX

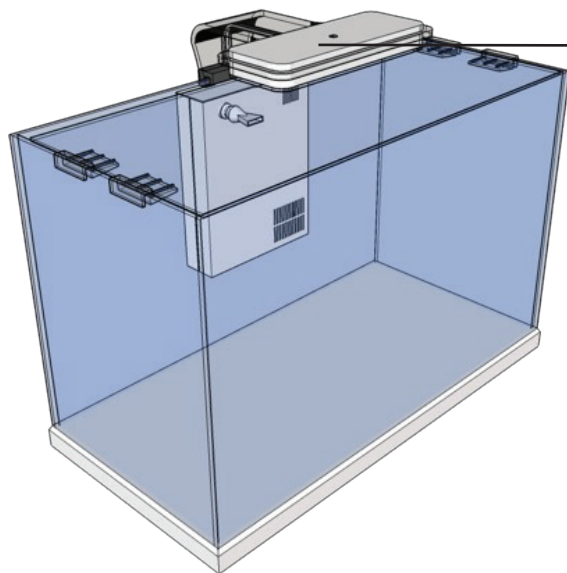

Versa 9.5 shown

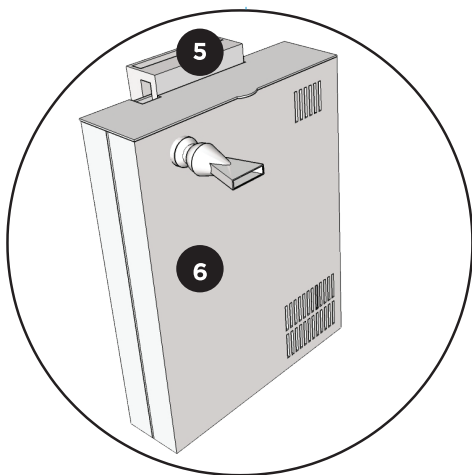
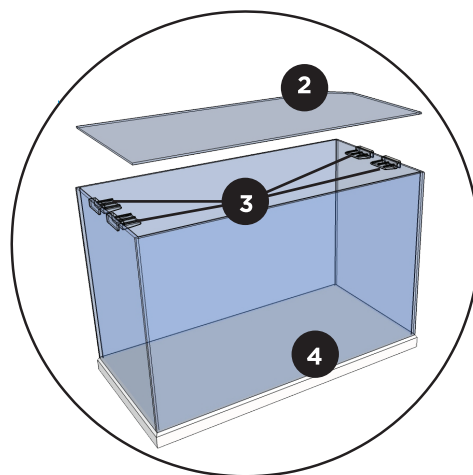
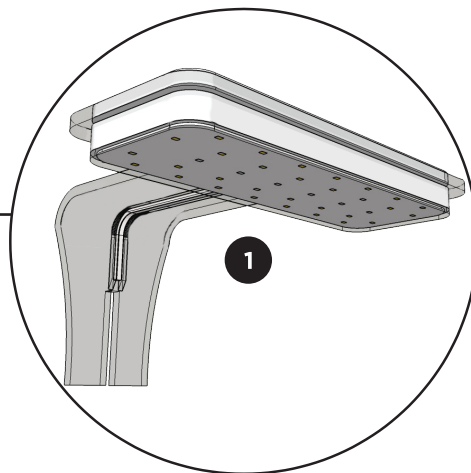

MAJOR COMPONENTS

1	LED light unit
2	Glass lid
3	Lid supports (x4)
4	Glass tank body
5	Filter mounting bracket
6	Filter

KNOW YOUR FILTER

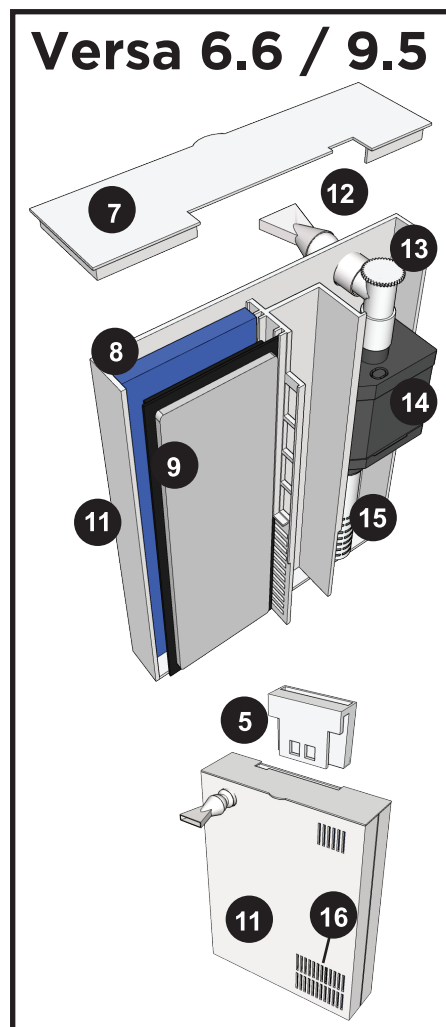
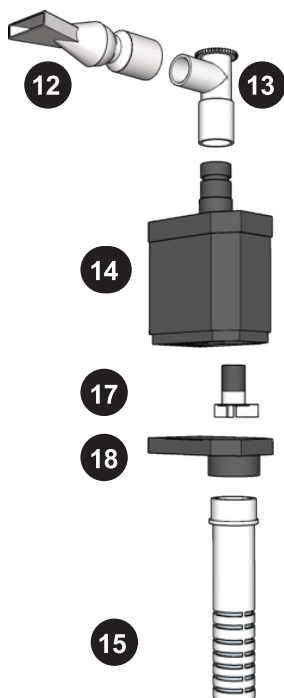
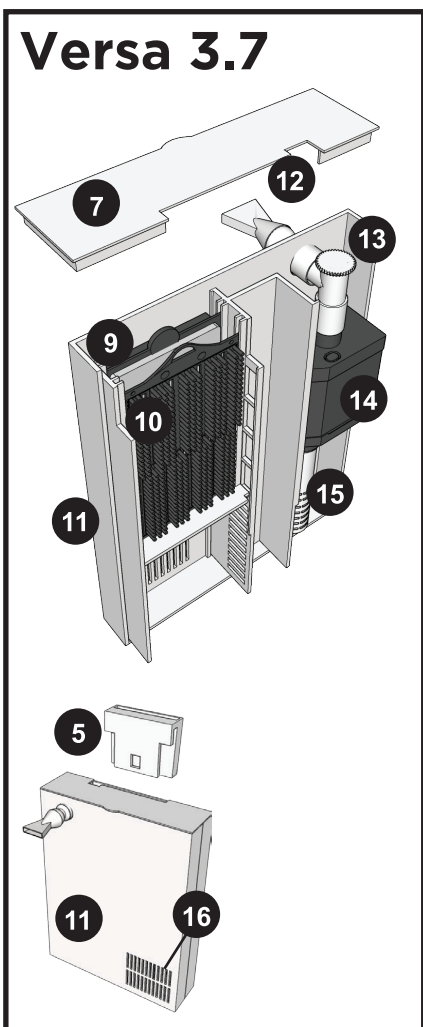

FILTER COMPONENTS

7	Filter lid	13	Elbow with adjustable flow valve
8	Filter sponge (Versa 6.6 & 9.5)	14	Powerhead
9	Carbon cartridge	15	Intake strainer
10	Bio cartridge (Versa 3.7)	16	Filter intake slots
11	Filter body	17	Impeller
12	Duckbill outlet	18	Impeller cover

IMAGITARIUM VERSA

3.7G / 6.6G / 9.5G



SETTING UP

Consider where you are going to place the aquarium. Avoid direct sunlight and areas that experience large temperature fluctuations such as near heaters or air conditioners.

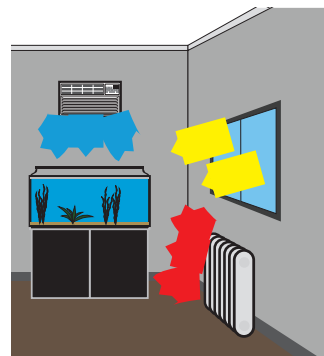

Place the aquarium on a level surface strong enough to support the weight of the aquarium, all equipment, substrate, décor and water in the aquarium.

Note that water is heavy (8.34 LB per gallon).

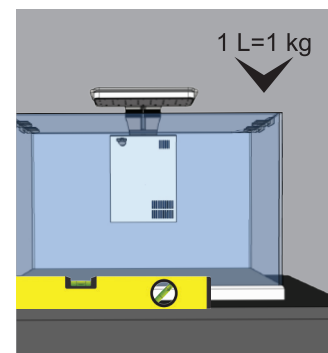

INSTALL FILTER

If you wish to keep tropical fish, install a heater* near the filter as shown. Do not plug the heater in unless it is fully submerged in water.

Attach mounting bracket and mount on the back wall of the aquarium.

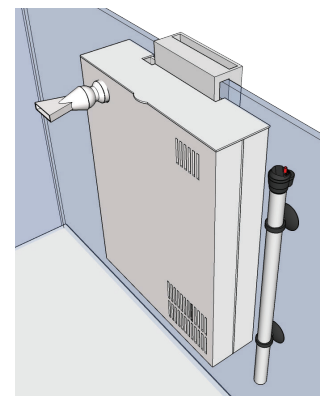
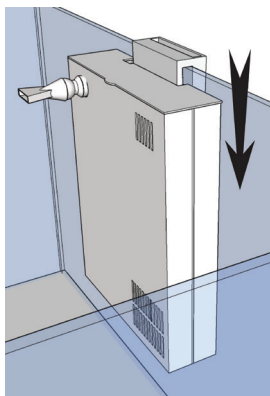
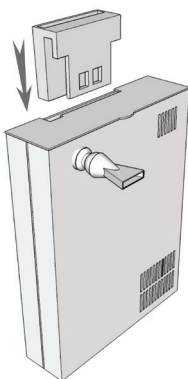

*Sold separately.

IMAGITARIUM VERSA

3.7G / 6.6G / 9.5G



ADD DECOR

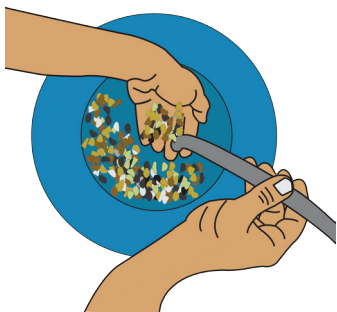

Rinse aquarium gravel* well.

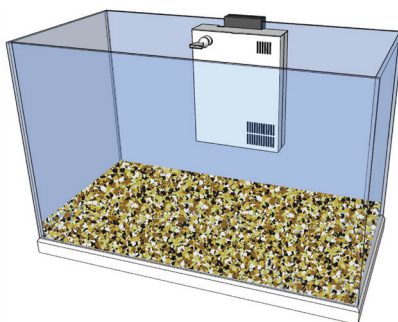

Gently pour the rinsed gravel into the aquarium.

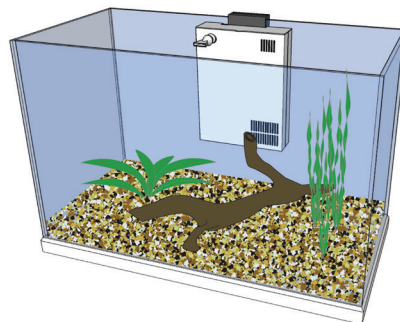

Rinse décor* and place into the aquarium as desired.

FILL AQUARIUM

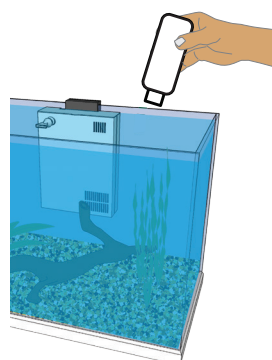
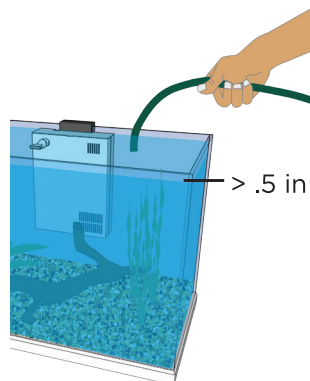

Fill the aquarium to no more than .5 IN below the top. Always treat the water with a water conditioner* to remove harmful chemicals.

Ensure that all décor are securely placed so that they cannot fall over, which may harm aquarium inhabitants and damage the aquarium.

Ensure that your hands and all power cables are dry before plugging in equipment and turning power on.

*Sold separately.

IMAGITARARIUM VERSA

3.7G / 6.6G / 9.5G



PLACE LID

Place four lid supports as shown.

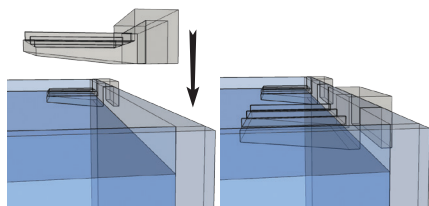

Place lid on lid supports.

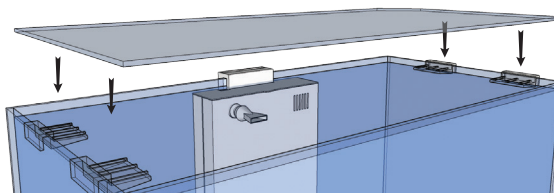

PLACE THE LIGHT

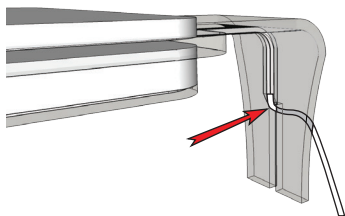

Feed light power cable through the gap in the stem.

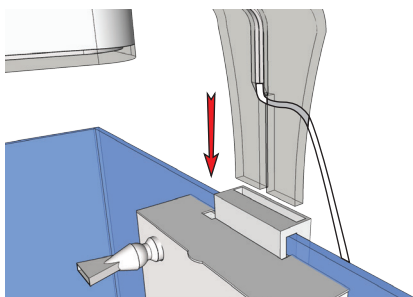

Insert the light unit stem into the slot at the top of the filter mounting bracket.

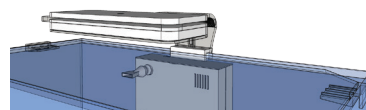

Ensure that the light is securely in place.

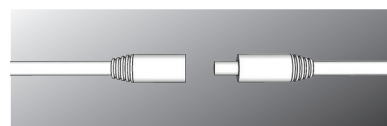

Connect the light and transformer power plugs.

USING THE FILTER

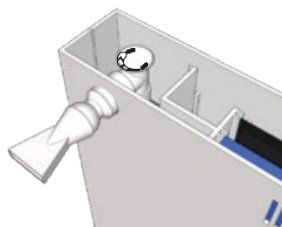

Use the adjustable flow nozzle to increase or decrease flow as needed.

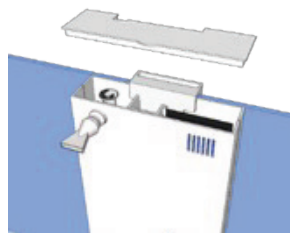

Place the cover back on the filter box after adjusting flow.

SETTING UP - CONTINUED

USING THE LIGHT

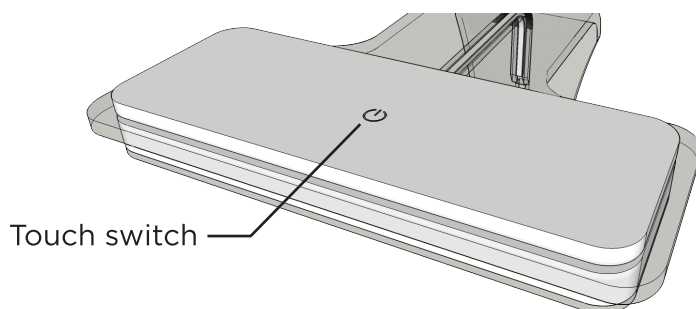

Press switch once



Press switch twice



Press switch three times



It is recommended that the light is turned completely off for at least 8 hours per day to allow the aquatic life a proper night period. More than 10 hours of full light daily can encourage excessive algae growth.

To maximize light quality, ensure that the light unit and aquarium lid are kept clean.

MAINTENANCE

DAILY

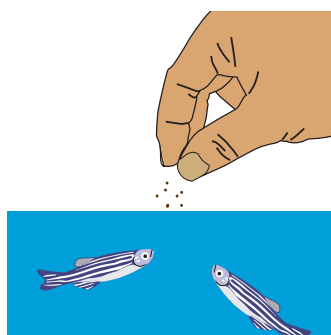

Feed aquatic life.

*Sold separately.

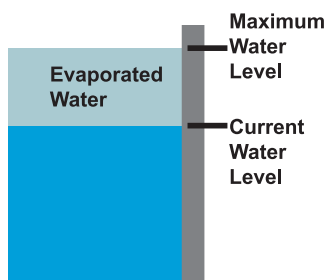

Check water level and top off if required.

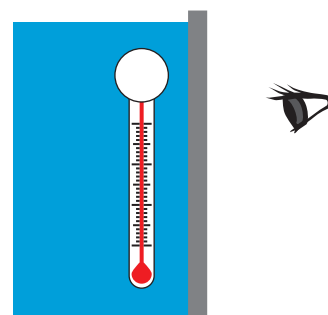

Check temperature of the water.

IMAGITARIUM VERSA

3.7G / 6.6G / 9.5G



WEEKLY

Test water parameters.

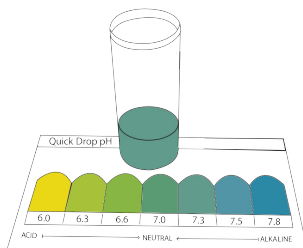

EVERY 2-4 WEEKS: 10-25% WATER CHANGE

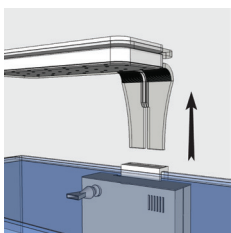

Remove glass lid and light unit. Unplug filter and heater (if equipped).

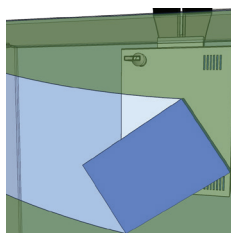

Use an algae scraper* to gently clean the glass and the outside of the filter.

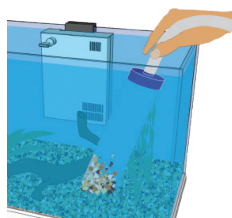

Use a gravel cleaner* to empty 10-25% of the aquarium water into a bucket.

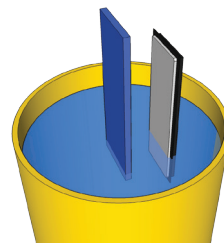

Every 2 weeks, remove and rinse the filter sponge and carbon cartridge in the old water from the aquarium.

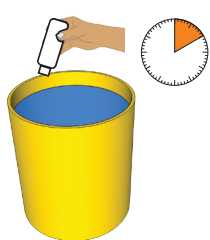

Fill the bucket with new water and treat it with water conditioner*. Follow water conditioner* instructions.

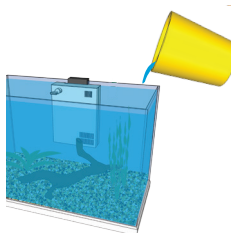

Gently refill the aquarium with the prepared water.

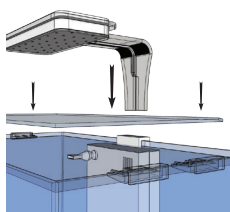

Replace all equipment in the aquarium. Check that your hands and power plugs are dry.

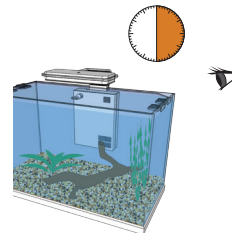

Check that all equipment is working correctly over the next half-hour.

Never rinse the sponge under the tap as you will kill the beneficial bacteria that live on the filter media and disrupt the balance of the tank.

Replace the carbon cartridge every 4 weeks.

Place the glass lid somewhere safe where it will not be broken while you are servicing the aquarium.

The aquatic life and plants do not need to be removed when doing regular maintenance. Place a towel on the floor in front of the aquarium in case of water spillage.

*Sold separately.

IMAGITARIUM VERSA

3.7G / 6.6G / 9.5G



MAINTENANCE - CONTINUED

Unplug all equipment before beginning work on any part of the aquarium.

MONTHLY - FILTER MAINTENANCE

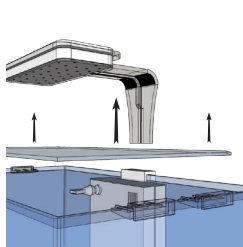

Remove glass lid and light unit.

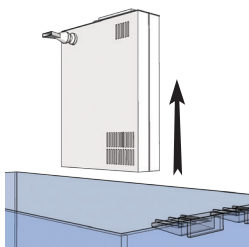

Remove filter from the aquarium.

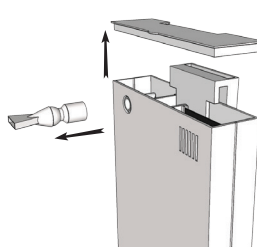

Remove filter lid and disconnect return duckbill.

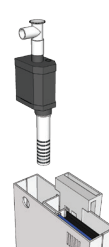

Lift out pump assembly from filter box.

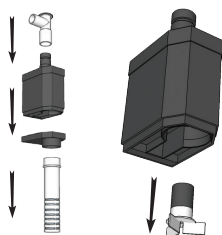

Remove elbow with adjustable flow valve, intake strainer, impeller cover and then the impeller.

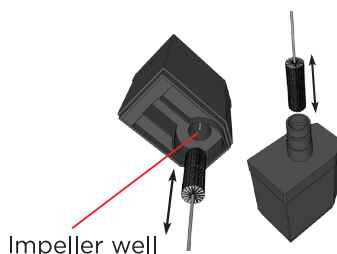

Impeller well

Use a pipe brush* to clean all pump components, paying particular attention to the impeller well.

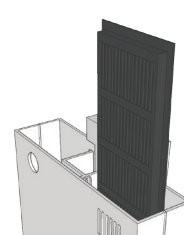

Replace carbon cartridge.

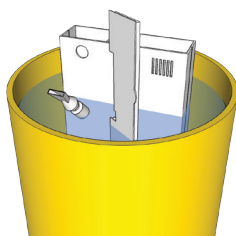

Rinse all other components of the filter to remove any debris or algae.

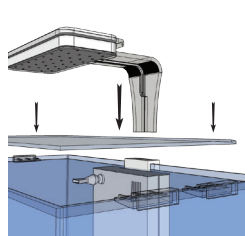

Replace all equipment on the aquarium. Check that your hands and power plugs are dry and turn power back on.

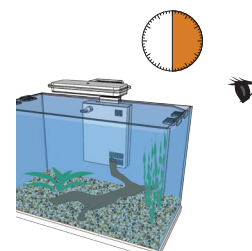

Check that all equipment is working correctly over the next half-hour.

*Sold separately.

Take care not to lose small parts when servicing the aquarium, especially when cleaning filter components at a sink.

IMAGITARIUM VERSA

3.7G / 6.6G / 9.5G



TROUBLESHOOTING

SLOW WATER FLOW

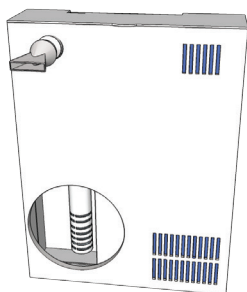

Check and clean intake strainer and filter intake.

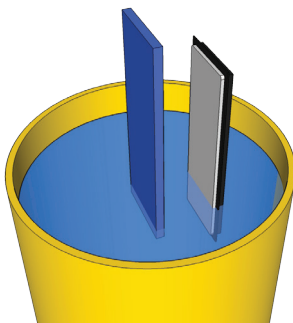

Clean filters to remove debris.

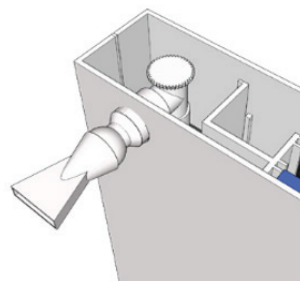

Check and adjust flow valve nozzle.

NO WATER FLOW

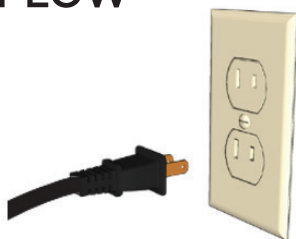

Check that power is available and connected properly.

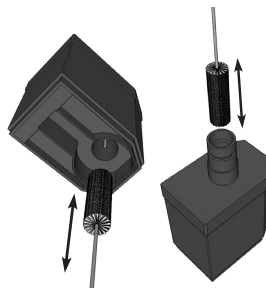

Clean powerhead to remove debris.

LIGHT WON'T TURN ON

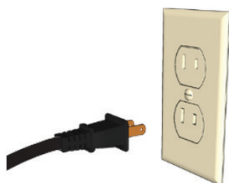

Check that power is available and connected properly.

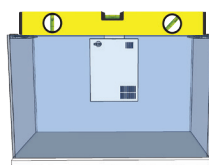

Check that aquarium is sitting level.

AQUARIUM POSSIBLY LEAKING

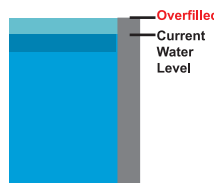

Make sure that the water level is not too high.

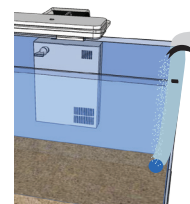

If an air stone* is being used, check that it is not bubbling water over the rim.

*Sold separately.

